

**East of White Bear Lake, and adjacent to St. Jude of the Lake Parish, Coventry of Mahtomedi is centrally located with access to sidewalks, residential neighborhoods, parks and lots of small town charm.** Our community is uniquely designed with resident apartments circled around central gathering areas. Because of this "neighborhood" design, residents can be more independent, and engaging in activities and socializing are made easy. Your neighbors in your neighborhood become family. Our professional and caring staff are always nearby, providing assistance when it's needed.

*Dellwood*  
Neighborhood  
First Floor

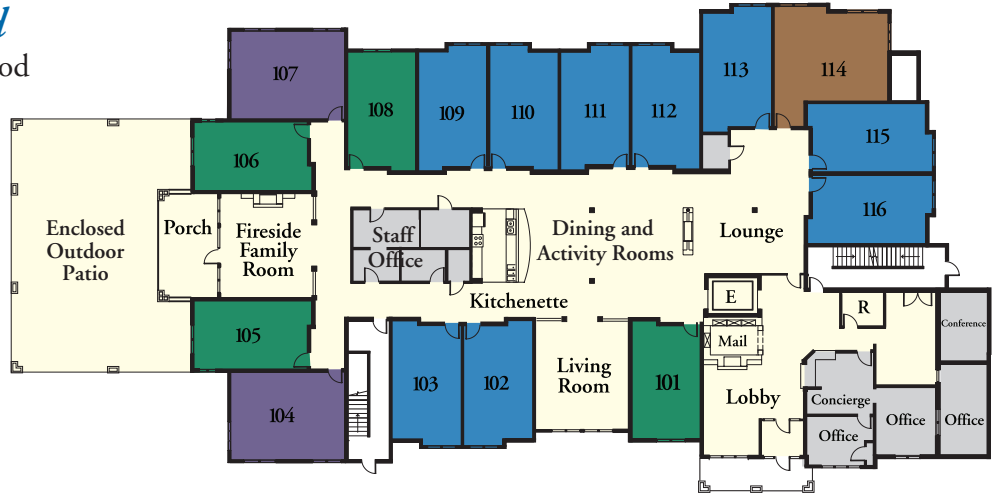

*Wedgewood*  
Neighborhood  
Second Floor

- Juniper Studio
- Maple Studio
- Hickory One-Bedroom
- Dahlia One-Bedroom



*Wildwood*  
Neighborhood  
Third Floor



**COVENTRY**  
of Mahtomedi  
*Assisted Living & Memory Care*

720 Mahtomedi Avenue  
Mahtomedi, MN 55115

**(651) 528-8442**

**CoventrySeniorLiving.com**



**EBENEZER**  
*Choices for vibrant senior living*